

Wood Cabinetry

User's Guide

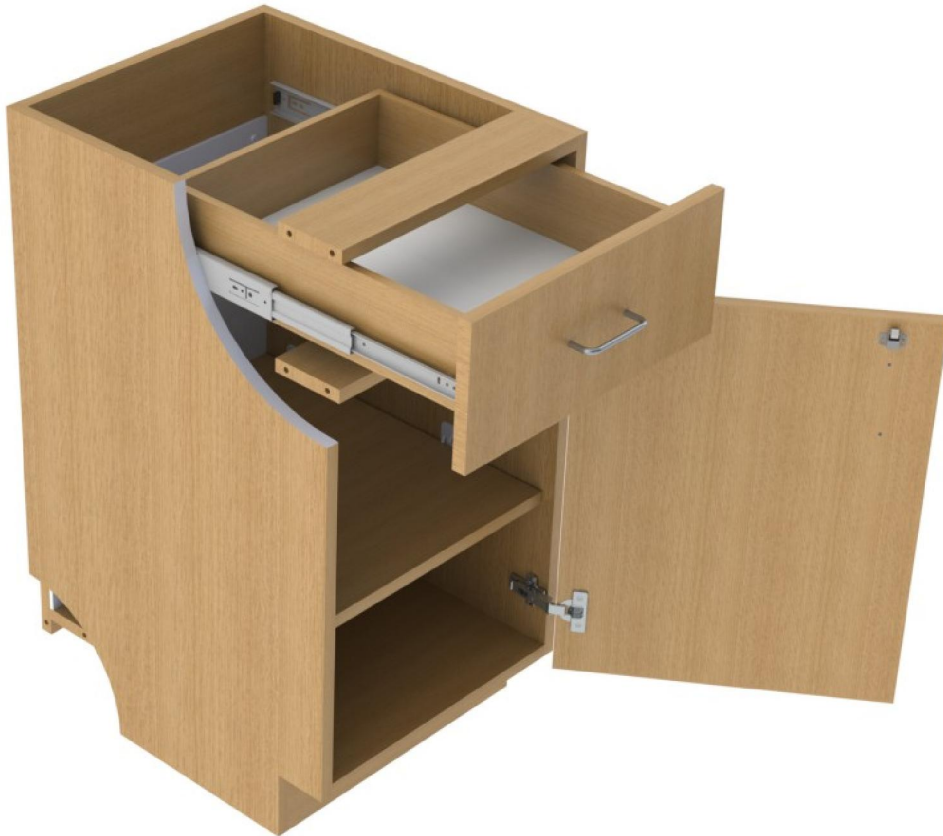

Mott Manufacturing LLC
P.O Box 156
562 Industrial Park Road
Maxwelton, West Virginia
USA, 24957

mott
MANUFACTURING

ISO 9001:2008 REGISTERED

SAVE THESE INSTRUCTIONS

Table of Contents

Cleaning	Pg.3
Back Panel Removal.....	Pg.3
Drawer Removal.....	Pg.4
Wall Cabinet Sliding Door Removal.....	Pg.4

Cleaning

Your wood laboratory cabinetry is protected by a chemical resistant UV cured finish that is designed to withstand a variety of chemicals. However, prolonged exposure may cause fading or discoloration. To assure that your new casework has a “Brand New” appearance for years, regularly clean all surfaces with a non-abrasive household cleaner such as 409 or similar. Keeping surfaces free of contamination also minimizes the chances of unwanted chemical reactions inside cabinets and on work surfaces.

Any painted surfaces of the cabinetry as well as the glass doors on upper cabinets should be wiped down regularly with glass cleaner.

(Note: Be sure that this cleaner is compatible with other chemicals within the laboratory)

Any stainless steel surface, countertops, or drawer bodies should be cleaned with stainless steel cleaner. Wipe only in the direction of the grain to ensure scratches do not form.

Removable Back Panels

To gain access to services behind cabinet:

- Remove shelf from cabinet.
- Remove Philips head screws and pull out panel.
- To replace panel. Return to original position in cabinet and reinstall screws.

Drawer Removal

Self-closing type drawer:

- Pull drawer out all the way, lift rear drawer roller over cabinet rollers and remove.
- To replace drawer; position rear drawer rollers behind cabinet rollers and push in to cabinet.

Full extension type drawer:

- Pull drawer out all the way, push down on plastic tabs and pull out to remove.
- To replace drawer push full extension slide all the way into cabinet.
- Line up channel on drawer housing with full extension channel in cabinet and push in. (Take care to line up runner channels as forcing them together may cause ball bearings to be dislodged.)

Wall Cabinet Sliding Door Removal

Sliding glass door removal and installation:

- Lift up on door and swing the bottom out.
- To replace doors: insert top of door into upper track and swing bottom of door onto lower retainer.

Framed glass sliding door removal and installation:

- Remove screws that hold lower plastic retainer in place.
- Swing out bottom of door and remove track.
- Swing out bottom of outer door until rollers will disengage from upper track (if applicable) and remove door.
- Repeat for inner door.
- To replace door, hook top of inner door over inner track and swing door down.
- Repeat for outer door on the front track.
- Attach lower plastic track and reinstall screws.